



SUBMITTAL SHEET

Product(s): Trim-Tex Shadow Bead

Description: Trim-Tex Shadow Beads are used to create a reveal effect when butting up to door jams, base trims, ceilings and light boxes. Available in multiple widths.

Advantages: Qualifies for LEED® points. Can be flexed to conform to curving walls and soffits. Made from rust proof, dent resistant PVC to reduce jobsite and handling damage. Built in expansion virtually eliminates edge cracking.

Limitations: Product is designed for interior use.

Applicable Standards: Rigid PVC products made by Trim-Tex meet ASTM specifications D3678-97, D1784-03, C1047-99 and achieve a Class A rating for flame spread and smoke developed when tested under ASTM E84-10.

Surface Characteristics: Trim-Tex products are made from PVC. PVC does not support combustion and is self extinguishing when the source of flame or heat is removed.

Installation: Snip the bead to length and dry fit. Install with Trim-Tex 847 Spray Adhesive and 1/2" divergent staples. Detailed installations instructions are included with each product.

Finishing: To improve the bondability of drywall compounds, textures & plaster products to any bead, use MUD-MAX Drywall Compound Additive. For texture finishes. Priming is not required. Always use a high quality paint.

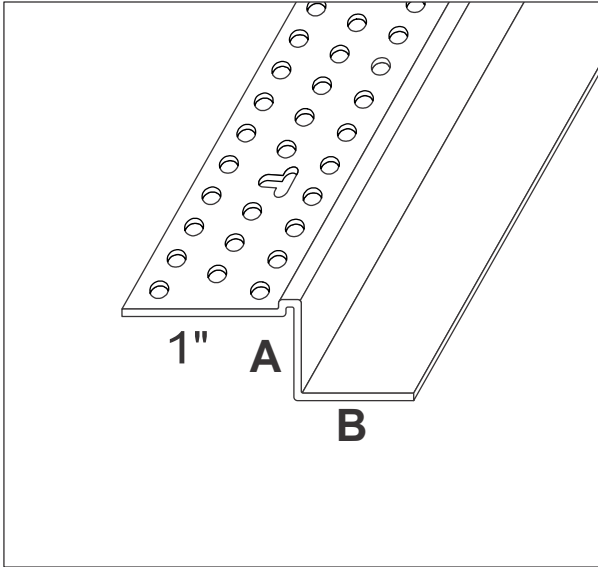

| STOCK NUMBER | A X B SIZE | LENGTH | PCS PER BOX |
|--------------|-------------|--------|-------------|
| 5410 | 1/2" X 1/4" | 10' | 50 |
| 5510 | 1/2" X 1/4" | 10' | 50 |
| 5610 | 1/2" X 3/4" | 10' | 50 |
| 5650 | 1/2" X 1" | 10' | 50 |
| 5710 | 5/8" X 1/4" | 10' | 50 |
| 5750 | 5/8" X 3/8" | 10' | 50 |
| 5810 | 5/8" X 1/2" | 10' | 50 |
| 5910 | 5/8" X 3/4" | 10' | 50 |
| 5950 | 5/8" X 1" | 10' | 50 |
| 6010 | 5/8" X 5/8" | 10' | 50 |

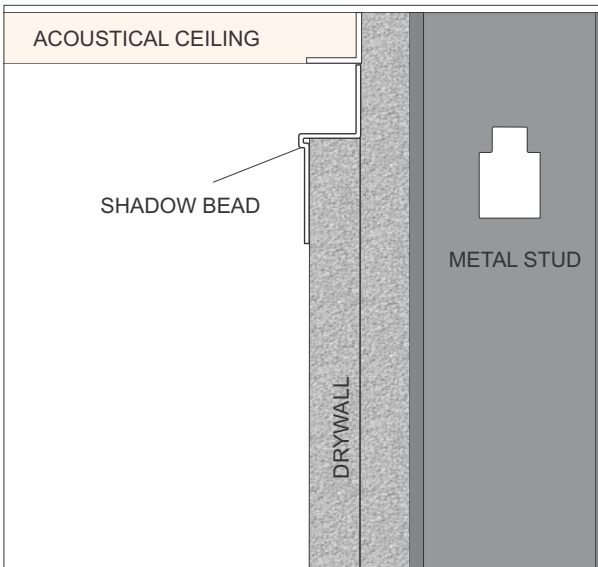

Job Name _____

Contractor _____ Date _____

Approvals (Signatures or Stamps)