

DRYWALL CONTRACTOR

Securock® ExoAir® 430 System

Introducing the Securock® ExoAir® 430 System—the first integrated gypsum sheathing panel with a factory-applied fluid air barrier membrane. The panel brings two proven technologies together—USG Securock® Brand Glass-Mat Sheathing and Tremco's fluid-applied air/water barrier membrane into one panel—that gives you an efficient delivery of the air barrier solution to your job site.

The controlled factory application of the membrane to the face of the panel provides the assurance that only a traditional thick-film membrane can. The system provides the continuity with a direct connection of the sealant to the membrane, giving you the visual verification to install with confidence.

When installed with the approved detailing accessories, the system reduces job-site challenges, simplifies installation and results in superior control of air, water and vapor.

- **Trained/approved installers**
- **Contractor estimating/bidding support**
- **Preconstruction and on-site technical support**
- **Win more work and increase revenue**
- **Suitable substrate for a variety of facades including adhesively applied EIFS**

BOARD JOINTS/FASTENER HEADS

In Plane Board Joints

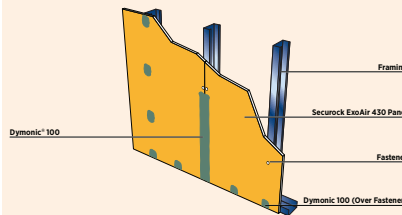

ROUGH OPENINGS

Rough Opening – Dymonic 100

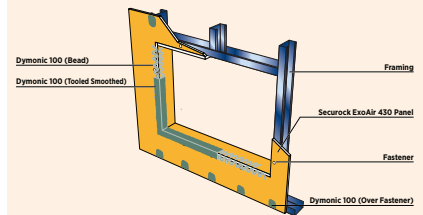

INSIDE CORNERS

Inside Corner

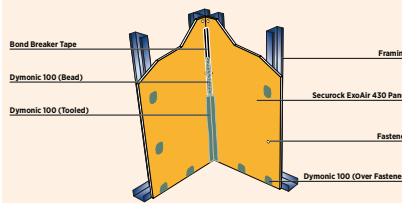

OUTSIDE CORNERS

Outside Corner – Dymonic 100

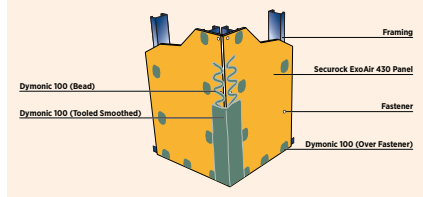

BENEFITS

- Competitive advantage with the support of two trusted brands
- Proven products individually, now proven together
- Preapplied air barrier membrane—install sheathing and air barrier at the same time
- Minimize field-applied challenges like weather impact and overspray
- Requires one crew and no new tools
- A full system that is tested and certified to be compatible

Product information

See securockexoair.com for the most up-to-date product information.

The product is warranted to be free of defects in materials at the time of shipment, but the manufacturer makes no warranty as to appearance or color. Since methods of application and on-site conditions are beyond the manufacturer's control and can affect performance, the manufacturer makes no other warranty, expressed or implied. ALL OTHER WARRANTIES, INCLUDING BUT NOT LIMITED TO THE IMPLIED WARRANTY OF MERCHANTABILITY AND THE IMPLIED WARRANTY OF

FITNESS FOR A PARTICULAR PURPOSE, ARE HEREBY EXPRESSLY DISCLAIMED. The manufacturer's sole obligation with respect to any product that fails to conform to the warranty set forth herein shall be, at its sole option, to replace or refund the purchase of the quantity of product proven to be defective. In no event shall the manufacturer be liable for any special, incidental or consequential damages in connection with the product or its use.

Note

Products described here may not be available in all geographic markets.

Notice

We shall not be liable for incidental and consequential damages, directly or indirectly sustained, nor for any loss caused by application of these goods not in accordance with current printed instructions or for other than the extended use. Our liability is expressly limited to replacement of defective goods. Any claim shall be deemed waived unless made in writing to us within thirty (30) days from the date it was or reasonably should have been discovered.

Safety First

Follow good safety/industrial hygiene practices during installation. Wear appropriate personal protection equipment.

Read SDS and literature before specification and installation.