

SUBMITTAL SHEET

Product(s): Architectural Reveal Beads & Intersections

Description: Trim-Tex Architectural Reveal Beads are used to create 1/4" or deeper reveals in drywall, and are available in multiple widths. Architectural Reveal Beads are great for breaking up the monotony of long drywall runs. Can be used vertically, horizontally, at an angle or any combination.

Advantages: Qualifies for LEED® points. 1/4" x 1/4" reveal is perfect for creating fine line details and can be flexed to conform to curving walls and soffits. Made from rust proof, dent resistant PVC to reduce job site and handling damage. Built in expansion virtually eliminates edge cracking.

Applicable Standards: Rigid PVC products made by Trim-Tex meet ASTM specifications D3678-97, D1784-03, C1047-99 and achieve a Class A rating for flame spread and smoke developed when tested under ASTM E84-10.

Surface Characteristics: Trim-Tex products are made from PVC. PVC does not support combustion and is self extinguishing when the source of flame or heat is removed. UV stabilized for use in exterior applications.

Installation: Snip the bead to length and dry fit. Install with Trim-Tex 847 Spray Adhesive and 1/2" divergent staples. Detailed installation instructions are included with each product.

Finishing: To improve the bondability of drywall compounds, textures, & plaster products to any bead, use MUD-MAX Drywall Compound Additive. For texture finishes, TEX11 Texture Prep is recommended on beads with exposed PVC surfaces such as Bullnose, Super L Beads and Fast Caps. Priming is not required. Always use a high quality paint. North Safety Products are distributed by Trim-Tex.

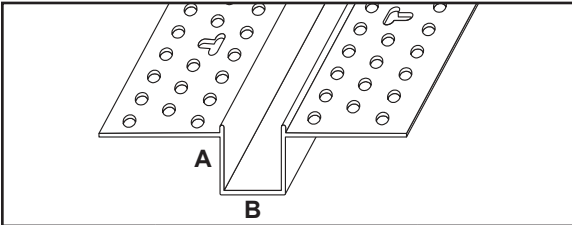

Stock No.	A+B Size	Length	Pcs. Per Box
AS5150	1/4" x 1/4"	10'	25
AS5170	1/4" x 3/4"	10'	15
AS5160	1/2" x 1/4"	10'	20
AS5110	1/2" x 1/2"	10'	20
AS5210	1/2" x 3/4"	10'	15
AS5310	1/2" x 1"	10'	15
AS5320	5/8" x 1/2"	10'	15
AS5325	5/8" x 5/8"	10'	15
AS5160	1/2" x 1/4"	10'	20
AS5340	5/8" x 1"	10'	15
AS5350	5/8" x 2"	10'	10

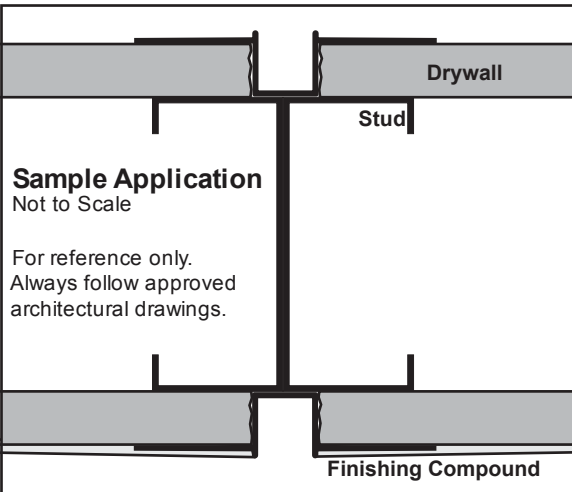
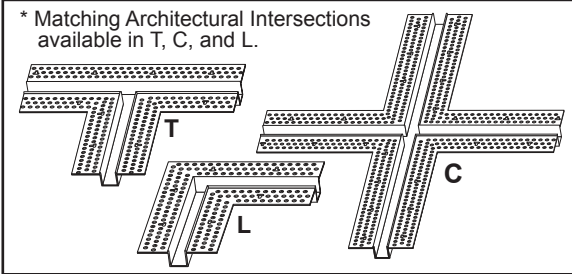

Job Name _____

Contractor _____ Date _____

Architectural Reveal Radius Chart

Minimum inside and outside radius the reveal can finish

STOCK NO.	A+B SIZE	INSIDE	OUTSIDE
AS5150	1/4" x 1/4"	1'	1'
AS5170	1/4" x 3/4"	2'	2'
AS5110	1/2" x 1/2"	6'	3'
AS5210	1/2" x 3/4"	8'	6'
AS5310	1/2" x 1"	9'	4'
AS5320	5/8" x 1/2"	8'	4'
AS5325	5/8" x 5/8"	9'	4'
F REVEAL			
AS8710	1/2" x 1/2"	7'	6'
AS8730	1/2" x 3/4"	7'	6'
AS8740	1/2" x 1"	8'	6'
AS8750	5/8" x 5/8"	9'	7'
Z SHADOW			
AS5510	1/2" x 1/2"	12'	20'
AS5610	1/2" x 3/4"	12'	20'
AS5810	5/8" x 1/2"	20'	25'
AS6010	5/8" x 5/8"	20'	25'
AS5910	5/8" x 3/4"	20'	25'

Approvals (Signatures or Stamps)